

- | | | | |
|----------------|-------------|--|------------------------|
| FFDER | • ECM Motor | • Room Side Replaceable Filter | • Forward Inclined Fan |
| FFDERA | • ECM Motor | • Room Side Replaceable Filter & Motor | • Forward Inclined Fan |
| FFDERAC | • ECM Motor | • Room Side Replaceable Filter, Motor & Controls | • Forward Inclined Fan |

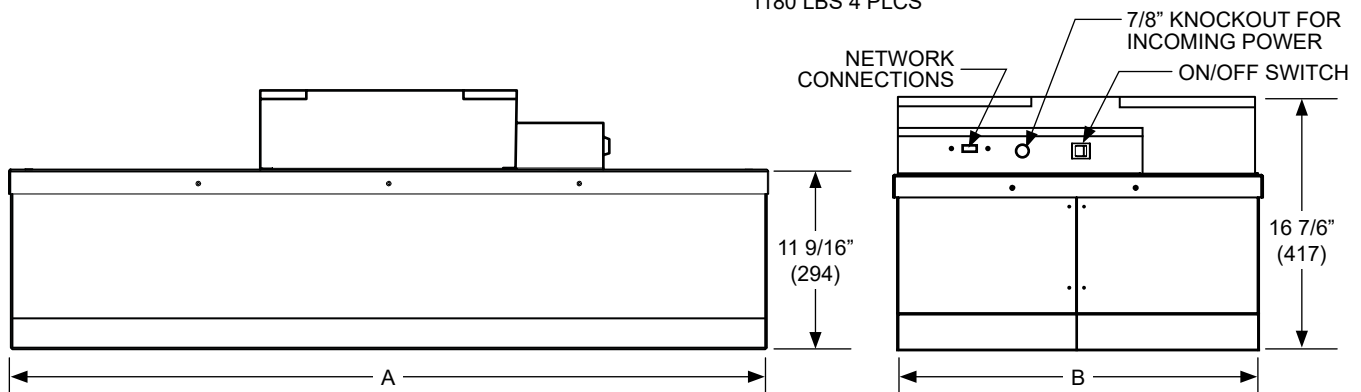
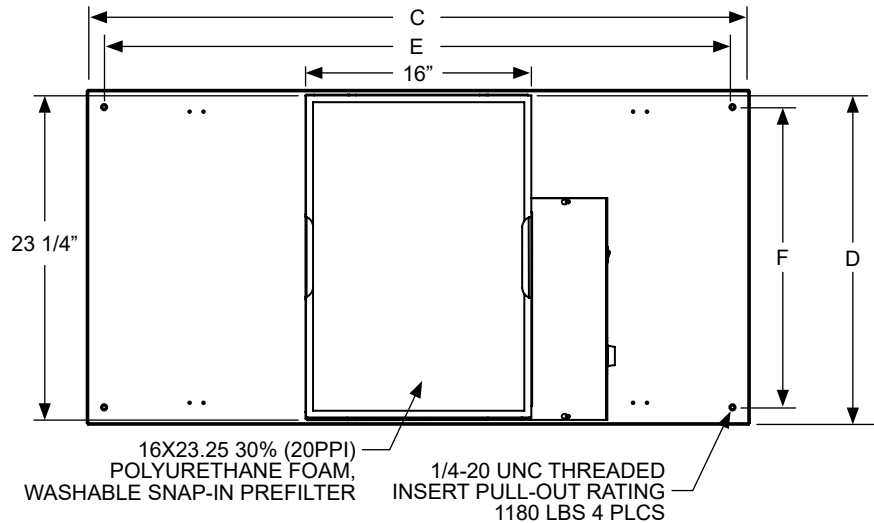

Unit Size	A	B	C	D	E	F
	In (mm)	In (mm)	In (mm)	In (mm)	In (mm)	In (mm)
24" X 24"	23 5/8 (600)	23 5/8 (600)	23 3/8 (606)	23 3/8 (606)	21 3/8 (543)	21 3/8 (543)
	35 5/8 (905)	23 5/8 (600)	35 3/8 (905)	23 3/8 (606)	33 3/8 (847)	21 3/8 (543)
36" X 24"	47 5/8 (1200)	23 5/8 (600)	47 3/8 (1215)	23 3/8 (606)	45 3/8 (1152)	21 3/8 (543)

Note: Maximum inlet static pressure is 0.30 inches of water. Operating above the maximum may adversely affect the performance of the unit and is not recommended.

General Description

- Titus Fan Filter Diffusers provide constant unidirectional airflow to occupied space
- FFDER offers high performance, low energy usage & low noise levels for use in cleanroom applications
- Low profile design is great for applications with limited ceiling plenum space
- Walkable plenum (excluding pre-filter), rated at 250 lbs
- EC motor with forward curved centrifugal fan
- Aerosol Challenge port and concentration port
- Snap-in prefilter allows for easy replacement and maintenance
- Tested to IEST recommended standards
- UL 507 Listed with standard UL 900 filters

This Submittal is meant to demonstrate general dimensions and information of this product. The drawings are not meant to detail every aspect of the product. Drawings are not to scale. Titus reserves the right to make changes without written notice.

All rights reserved. No part of this work may be reproduced or transmitted in any form or by any means, electronic or mechanical, including photocopying and recording, or by any information storage retrieval system without permission in writing from Air Distribution Technologies.

HEPA Filter and Motor Replacement Detail

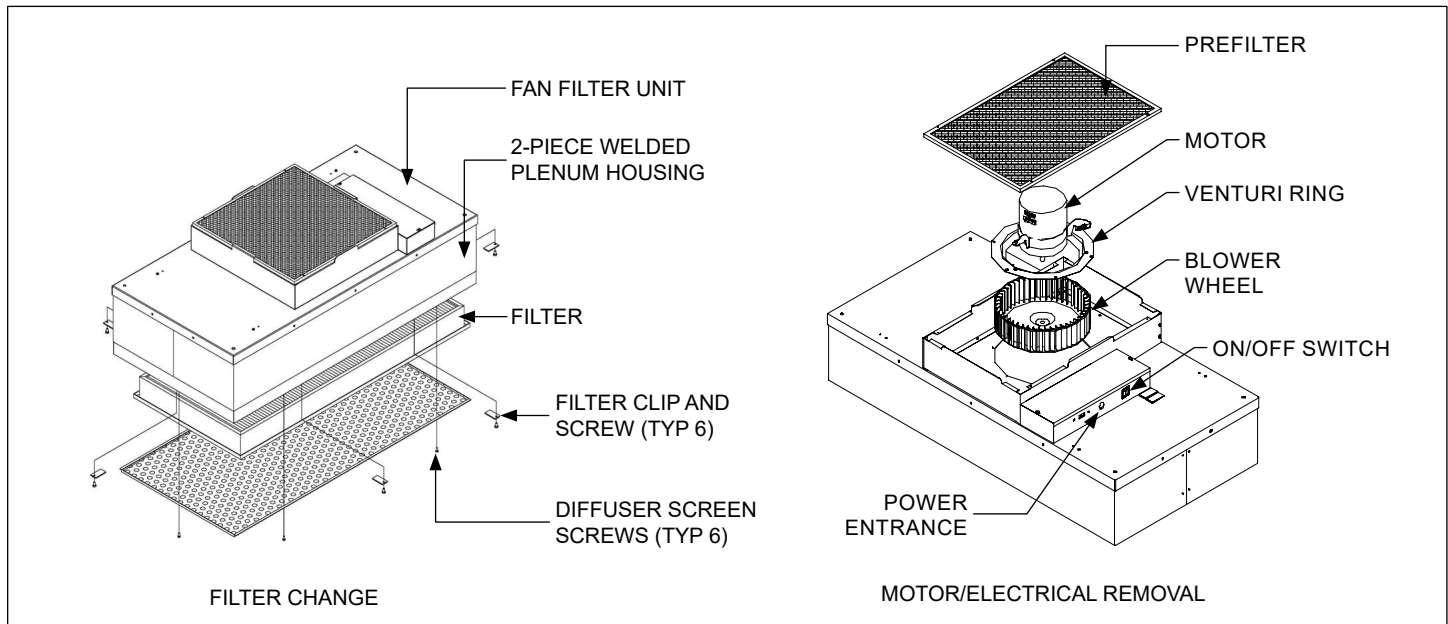

Basic Unit Configuration

Check ☒ if provided.

Module Size

- ☐ 24" x 24"
☐ 36" x 24"
☐ 48" x 24"

Duct Collar

- ☐ None
☐ 10" Inlet (Shipped Loose)
☐ 12" Inlet (Shipped Loose)

Unit Construction

- ☐ Aluminum Face & Plenum
☐ Stainless Steel Face / Aluminum Plenum
☐ Stainless Steel Face & Plenum

Finish

- ☐ #04 Mill Finish
☐ #26 White

Motor Type

- ☐ 115V/ 60 Hz/ 1 Phase ; FLA = 5.0A
☐ 208-240V/ 50/60 Hz/ 1 Phase ; FLA = 3.0A
☐ 277V/ 60 Hz/ 1 Phase ; FLA = 2.5A

Control Type

- ☐ Universal Control Card (Constant CFM standard)
☐ TRQ - Low Air Flow / Constant Torque
☐ RPN - Constant Speed
☐ Remote Mounted VCU Control
 - Must order 11166-001 separately
 - Each unit requires qty 1 for control
☐ Infrared Speed Controller
 - Remote PN 63760 sold separately
 - Required qty 1 to adjust airflow on multiple units

Filter Type

- ☐ HEPA (99.99%@0.3 micron)
☐ ULPA (99.9995%@0.12 micron)

Accessories (Optional)

Check ☒ if provided.

- ☐ Airflow Indicator Light (GREEN)
☐ Surface Mount Adapter
☐ Filter Load Indicator (RED)
☐ Insulation
☐ Continuous Filter Monitoring (0-10 V signal)
☐ Filter Ships Loose

This Submittal is meant to demonstrate general dimensions and information of this product. The drawings are not meant to detail every aspect of the product. Drawings are not to scale. Titus reserves the right to make changes without written notice.

All rights reserved. No part of this work may be reproduced or transmitted in any form or by any means, electronic or mechanical, including photocopying and recording, or by any information storage retrieval system without permission in writing from Air Distribution Technologies.

Challenge/Concentration Port Detail

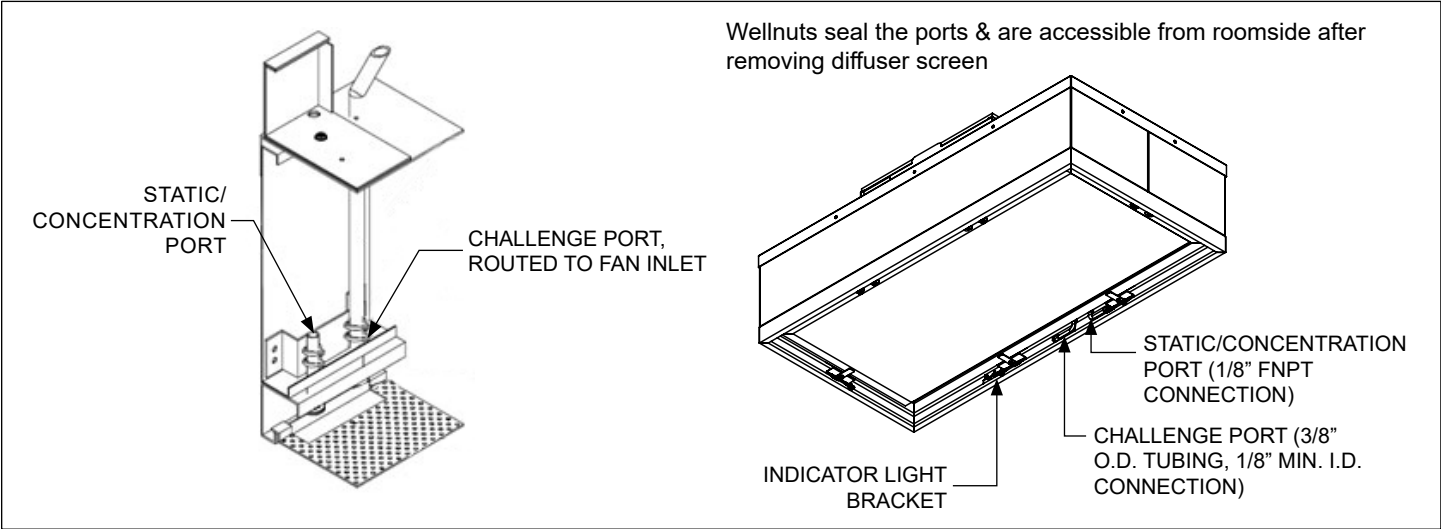

Inlet Adapter Accessory Detail

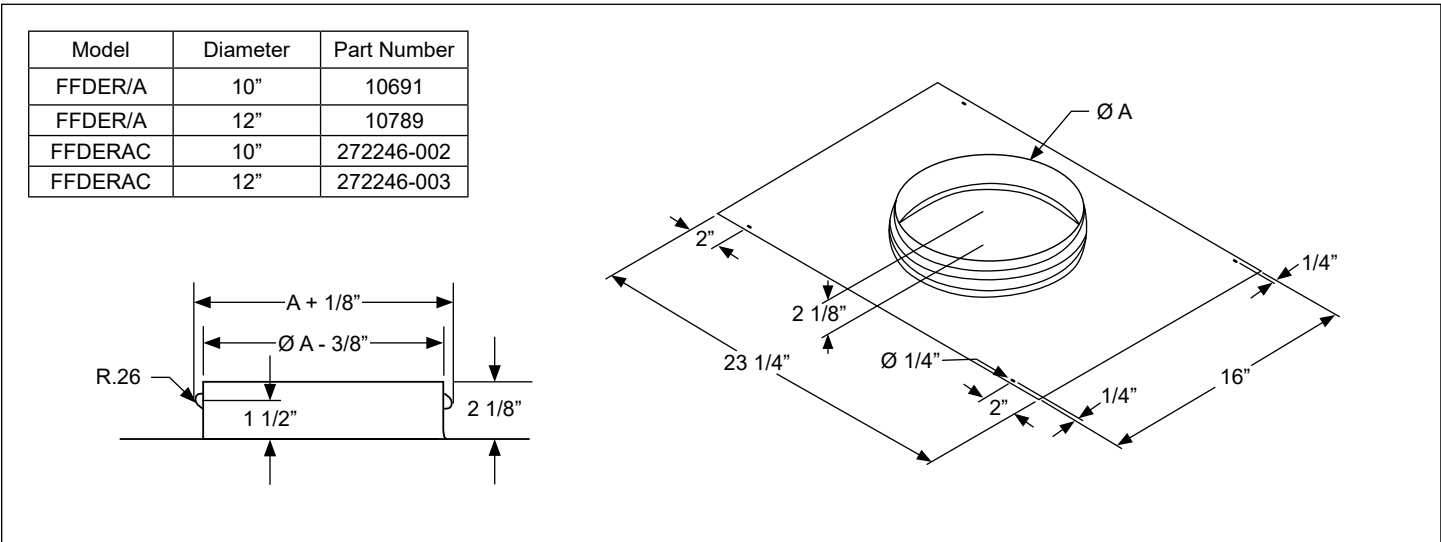

Surface Mount Adapter Accessory Detail

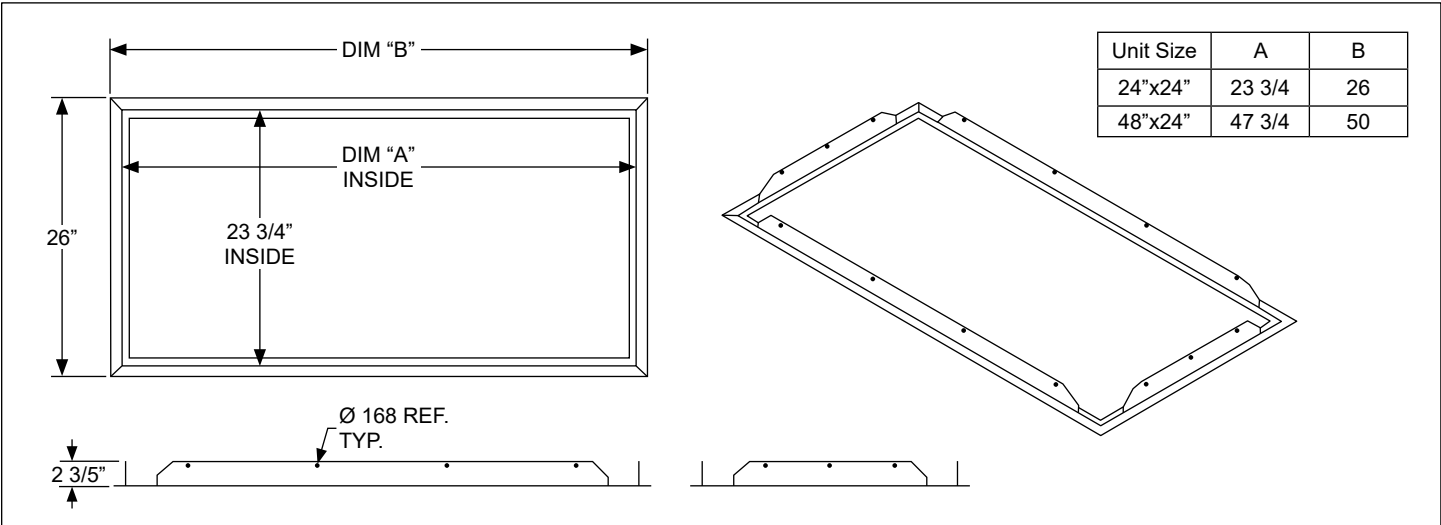

FFDBRAC Finger Guard Detail

